

---

# CIRCULATORS FOR HEATING AND AIR-CONDITIONING SYSTEMS



A



D



B



---

## GENERAL DATA

### Applications

Pump for circulating cold or hot water in small closed and pressurised or open tank civil and industrial community heating and air-conditioning systems.

### Construction characteristics

Pump body in cast iron and motor casing in die-cast aluminium.

Technopolymer impeller and tempered stainless steel driving shaft mounted on graphite brushings lubricated by the pumped liquid itself. Flanged vents, (threaded series A), provided with threaded connectors for controlling gauges. Stainless steel protective rotor sleeve, stator sleeve and closing flange. Ceramic thrust bearing, E.P.D.M. "O" rings and brass air outlet cap. The two-pole asynchronous motor with wet rotors designed for three-speed operation, single-phase version, for two-speed operation, for three-phase version. Thermal overload protection incorporated in the single phase version.

In the twin version an automatic clapet type valve and blank flange are provided.

Protection level: IP 44

Insulating class: F

Cable grommet: PG 11

Installation: with motor axis horizontal

Rated voltage: single-phase 230 V / 50 Hz

three-phase 400 V / 50 Hz

This product complies with EN 60335-2-51 European standard

# CIRCULATORS FOR HEATING AND AIR-CONDITIONING SYSTEMS

## TECHNICAL DATA

N.	PARTS	MATERIALS
1	PUMP BODY	CAST IRON
4	IMPELLER	TECHNOPOLYMER
7A	DRIVE SHAFT	STAINLESS STEEL
7B	ROTOR	-
8	STATOR	-
9	CAPACITOR	-
10	MOTOR CASING	DIE CAST ALUMINIUM
11	AIR OUTLET CAP	BRASS
100	TERMINAL BOARD BOX	-
127	O-RING	E.P.D.M
128	STATOR SLEEVE	STAINLESS STEEL
129	ROTOR SLEEVE	STAINLESS STEEL
130	CLOSING FLANGE	STAINLESS STEEL
131	THRUST BOX SUPPORT	E.P.D.M
132	BRUSHINGS	GRAPHITE
133	THRUST BOX	CERAMICS

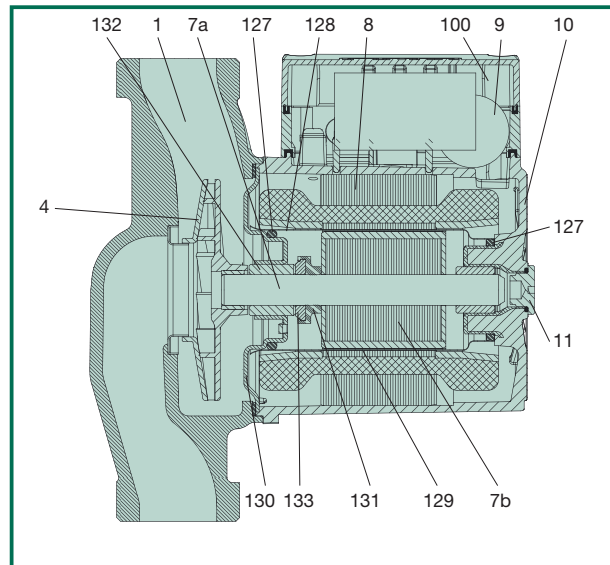

- Denomination index:  
(example)

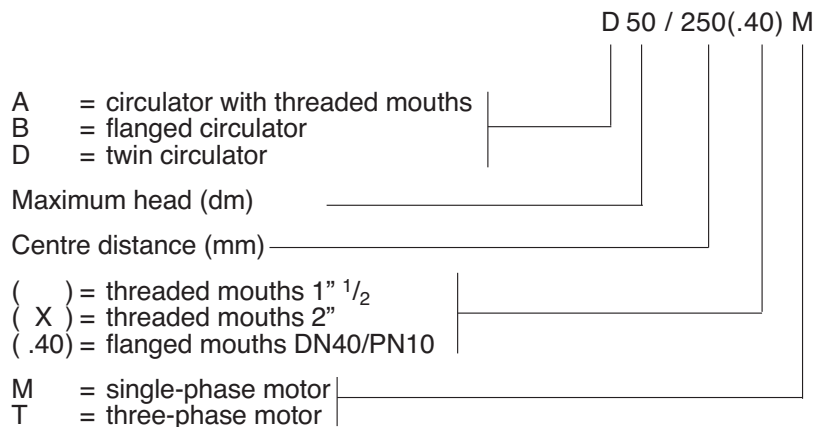

- Operating range: from 1 to 12 m<sup>3</sup>/h with head up to 11 metres.
- Liquid temperature range: from -10°C to +110°C.
- Characteristics of pumped liquid: clean, free from solids and mineral oils, non viscous, chemically neutral, close to the characteristics of water (max. glycol 30%).
- Maximum operating pressure: 10 bar (1000 kPa).
- Minimum head pressure: values are shown in the relative tables.
- Installation: with MOTOR AXIS HORIZONTAL on the delivery or return piping, with intake port as near as possible to the expansion tank, higher than the maximum level of the boiler and as far away as possible from bends, elbows and unions, in order to prevent water turbulence and consequent noisiness.
- Special versions on request: other voltages and/or frequencies.
- Accessories: unions measuring 1/4" F - 3/4" F - 1" F - 1 1/4" F - 1 1/4" M  
 counter flanges DN40/PN10

Performance curves based on kinematic viscosity values equal to 1 mm<sup>2</sup>/s at a density equal to 1000 kg/m<sup>3</sup>. Curve tolerance in accordance with ISO9906.

# CIRCULATORS FOR HEATING AND AIR-CONDITIONING SYSTEMS

Liquid temperature range: from -10°C to +110°C  
 Maximum operating pressure: 10 bar (1000 kPa)

## A 50/180 XM SINGLE WITH UNIONS - SINGLE-PHASE

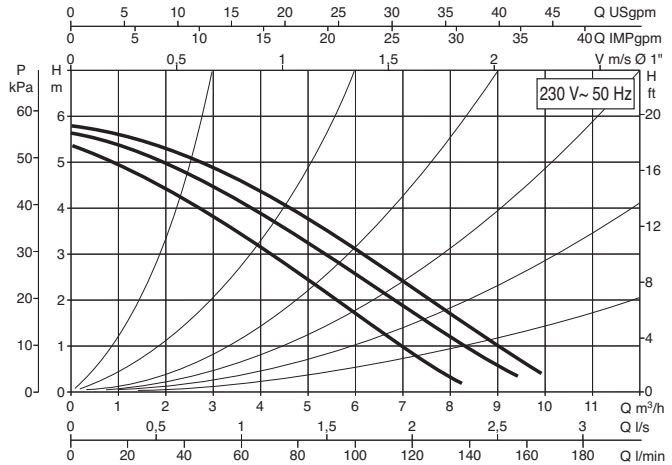
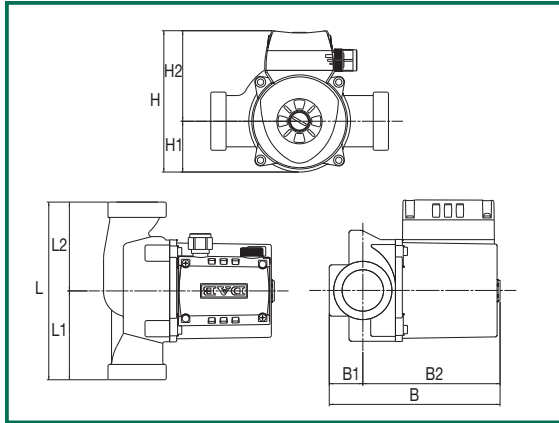

L	L1	L2	B	B1	B2	H	H1	H2	F	PACKING DIMENSIONS			VOLUME	WEIGHT
										L	B	H	m <sup>3</sup>	Kg
180	90	90	173	34	139	143	52	92	2" G	206	170	180	0,066	5,3

MODEL	VOLTAGE 50 Hz	CENTRE DISTANCE mm	UNIONS ON REQUEST	ELECTRICAL DATA						MINIMUM HEAD PRESSURE
				SPEED	N r.p.m.	P1 MAX W	In A	CAPACITOR µF	Vc	
A 50/180 XM	1x230 V ~	180	2" G	3	2791	184	0,92	4	400	t° +90°C mt. 1,5
				2	2651	189	0,92			
				1	2297	168	0,80			

## A 50/180 M SINGLE WITH UNIONS - SINGLE-PHASE

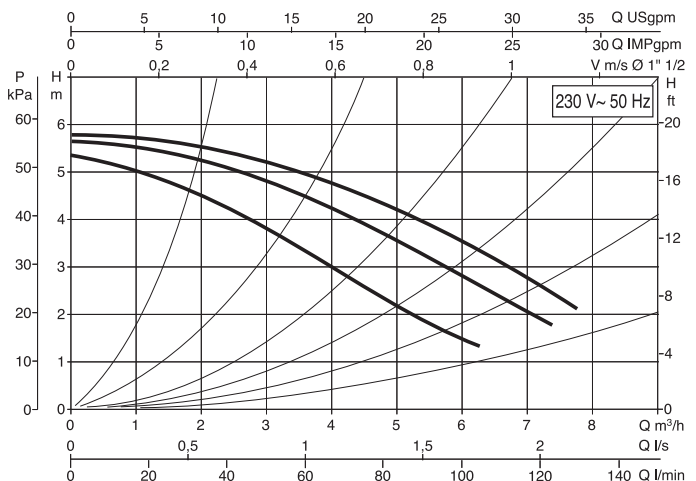
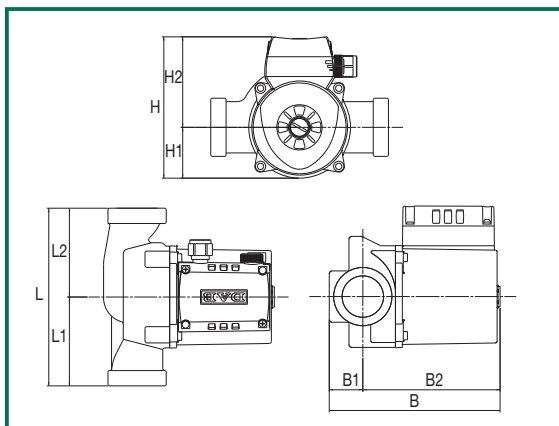

L	L1	L2	B	B1	B2	H	H1	H2	F	PACKING DIMENSIONS			VOLUME	WEIGHT
										L	B	H	m <sup>3</sup>	Kg
180	90	90	173	34	139	143	52	92	1" 1/2	206	170	180	0,066	5

MODEL	VOLTAGE 50 Hz	CENTRE DISTANCE mm	UNIONS ON REQUEST	ELECTRICAL DATA						MINIMUM HEAD PRESSURE
				SPEED	N r.p.m.	P1 MAX W	In A	CAPACITOR µF	Vc	
A 50/180 M	1x230 V ~	180	1" 1/2	3	2766	195	0,95	4	400	t° +90°C mt. 1,5
				2	2616	194	0,95			
				1	2215	180	0,85			

Performance curves based on kinematic viscosity values equal to 1 mm<sup>2</sup>/s at a density equal to 1000 kg/m<sup>3</sup>. Curve tolerance in accordance with ISO9906.

# CIRCULATORS FOR HEATING AND AIR-CONDITIONING SYSTEMS

Liquid temperature range: from -10°C to +110°C  
 Maximum operating pressure: 10 bar (1000 kPa)

## A 50/180 XT SINGLE WITH UNIONS - THREE-PHASE

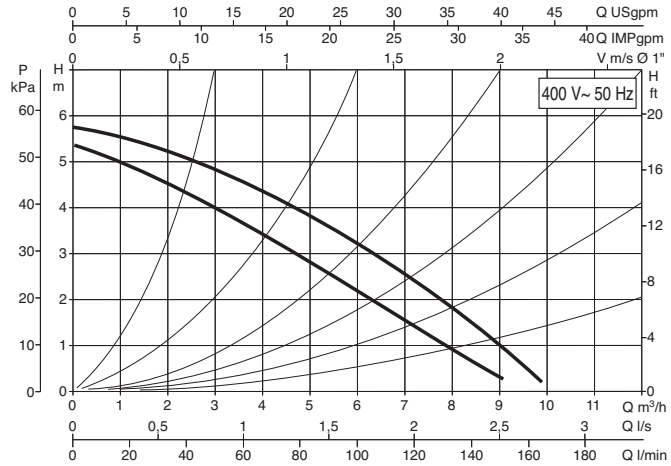
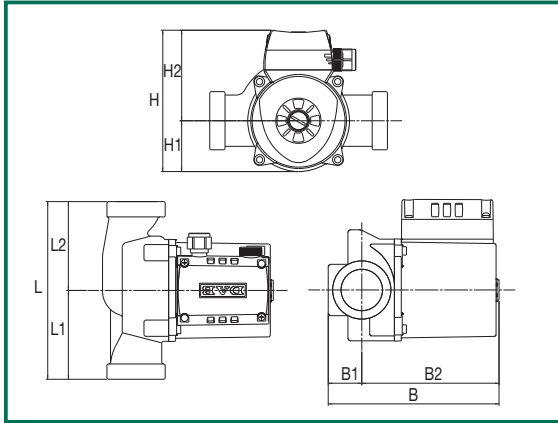

L	L1	L2	B	B1	B2	H	H1	H2	F	PACKING DIMENSIONS			VOLUME	WEIGHT
										L	B	H	m <sup>3</sup>	Kg
180	90	90	173	34	139	143	52	92	2" G	206	170	180	0,066	5,2

MODEL	VOLTAGE 50 Hz	CENTRE DISTANCE mm	UNIONS ON REQUEST	ELECTRICAL DATA						MINIMUM HEAD PRESSURE
				SPEED	N r.p.m.	P1 MAX W	In A	CAPACITOR		
								μF	Vc	
A 50/180 XT	3x400 V ~	180	2" G	2	2838	201	0,50	-	-	t° +90°C mt. 1,5
				1	2520	129	0,23			

## A 50/180 T SINGLE WITH UNIONS - THREE-PHASE

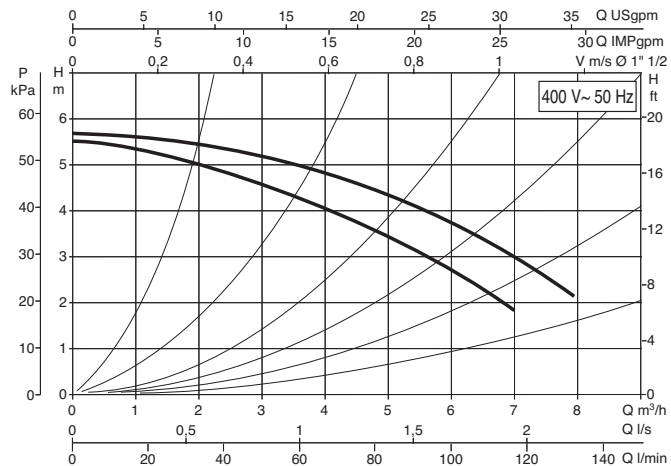
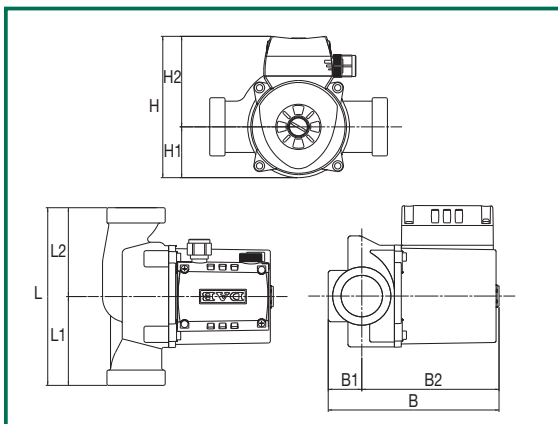

L	L1	L2	B	B1	B2	H	H1	H2	F	PACKING DIMENSIONS			VOLUME	WEIGHT
										L	B	H	m <sup>3</sup>	Kg
180	90	90	173	34	139	143	52	92	1" 1/2	206	170	180	0,066	5,3

MODEL	VOLTAGE 50 Hz	CENTRE DISTANCE mm	UNIONS ON REQUEST	ELECTRICAL DATA						MINIMUM HEAD PRESSURE
				SPEED	N r.p.m.	P1 MAX W	In A	CAPACITOR		
								μF	Vc	
A 50/180 T	3x400 V ~	180	1" 1/2	2	2827	197	0,52	-	-	t° +90°C mt. 1,5
				1	2502	139	0,25			

Performance curves based on kinematic viscosity values equal to 1 mm<sup>2</sup>/s at a density equal to 1000 kg/m<sup>3</sup>. Curve tolerance in accordance with ISO9906.

# CIRCULATORS FOR HEATING AND AIR-CONDITIONING SYSTEMS

Liquid temperature range: from -10°C to +110°C  
 Maximum operating pressure: 10 bar (1000 kPa)

## A 56/180 XM SINGLE WITH UNIONS - SINGLE-PHASE

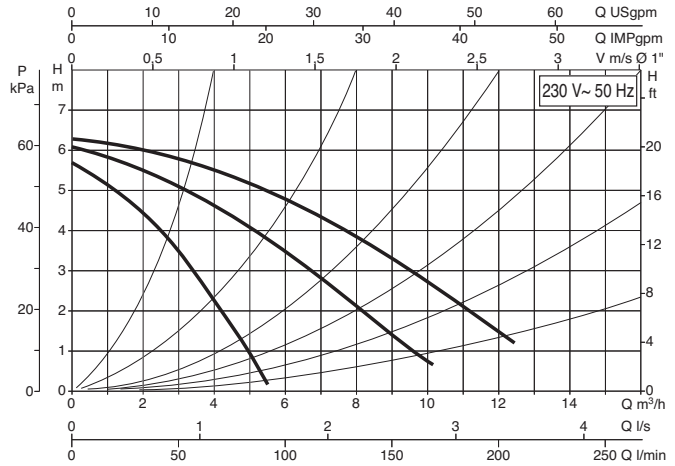
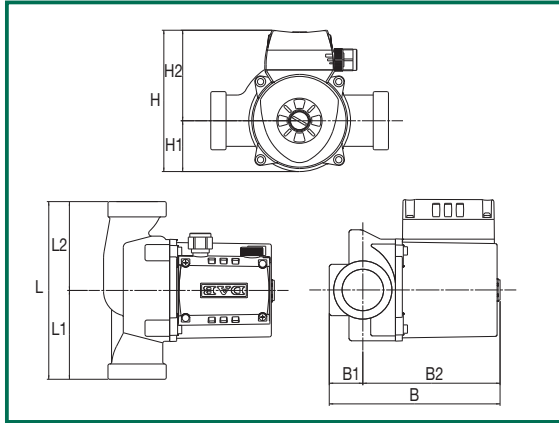

L	L1	L2	B	B1	B2	H	H1	H2	F	PACKING DIMENSIONS			VOLUME	WEIGHT
										L	B	H	m <sup>3</sup>	Kg
180	90	90	173	34	139	143	52	92	2" G	206	170	180	0,066	5,3

MODEL	VOLTAGE 50 Hz	CENTRE DISTANCE mm	UNIONS ON REQUEST	ELECTRICAL DATA						MINIMUM HEAD PRESSURE
				SPEED	N r.p.m.	P1 MAX W	In A	CAPACITOR µF	Vc	
A 56/180 XM	1x230 V ~	180	2" G	3	2658	271	1,18	7	400	t° +90°C mt. 1,5
				2	2117	294	1,32			
				1	1394	224	1,00			

## A 56/180 M SINGLE WITH UNIONS - SINGLE-PHASE

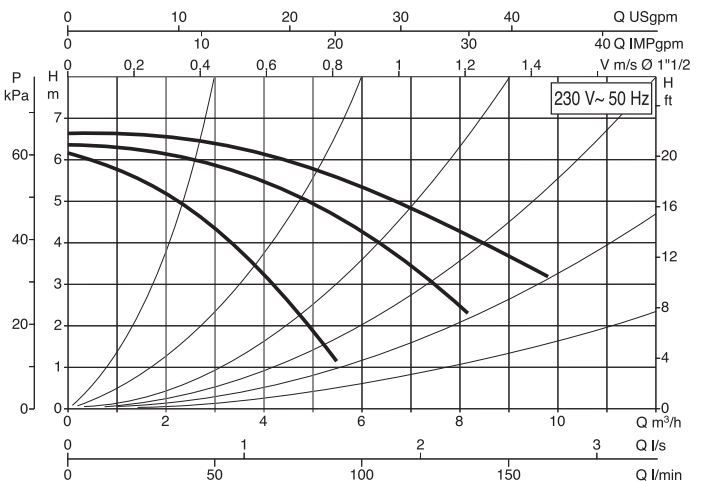
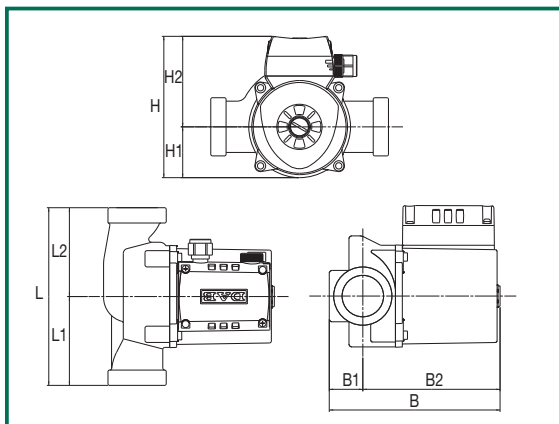

L	L1	L2	B	B1	B2	H	H1	H2	F	PACKING DIMENSIONS			VOLUME	WEIGHT
										L	B	H	m <sup>3</sup>	Kg
180	90	90	173	34	139	143	52	92	1" 1/2	206	170	180	0,066	5,3

MODEL	VOLTAGE 50 Hz	CENTRE DISTANCE mm	UNIONS ON REQUEST	ELECTRICAL DATA						MINIMUM HEAD PRESSURE
				SPEED	N r.p.m.	P1 MAX W	In A	CAPACITOR µF	Vc	
A 56/180 M	1x230 V ~	180	1" 1/2	3	2636	282	1,23	7	400	t° +90°C mt. 1,5
				2	2226	287	1,30			
				1	1485	228	1,06			

Performance curves based on kinematic viscosity values equal to 1 mm<sup>2</sup>/s at a density equal to 1000 kg/m<sup>3</sup>. Curve tolerance in accordance with ISO9906.

# CIRCULATORS FOR HEATING AND AIR-CONDITIONING SYSTEMS

Liquid temperature range: from -10°C to +110°C  
 Maximum operating pressure: 10 bar (1000 kPa)

## A 56/180 XT SINGLE WITH UNIONS - THREE-PHASE

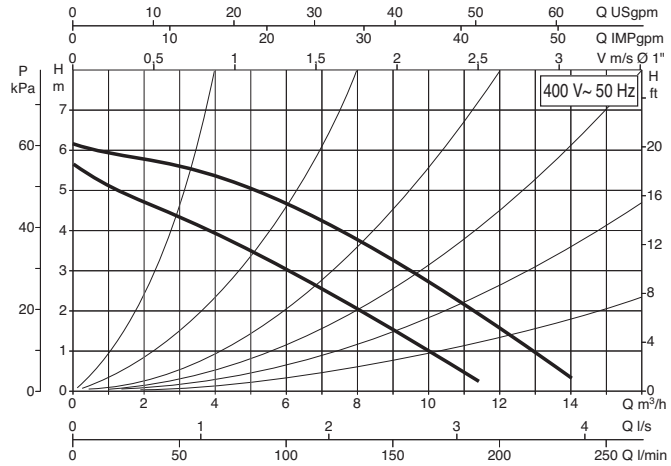
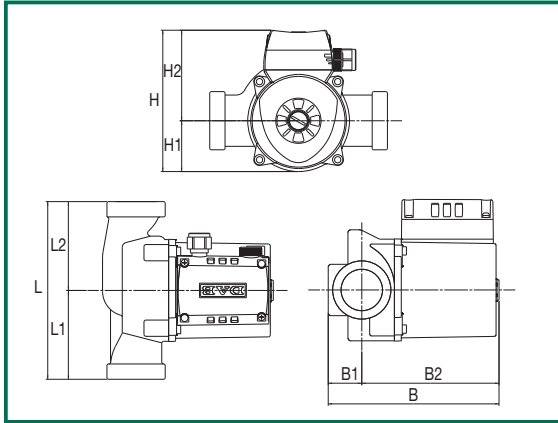

L	L1	L2	B	B1	B2	H	H1	H2	F	PACKING DIMENSIONS			VOLUME	WEIGHT
										L	B	H	m <sup>3</sup>	Kg
180	90	90	173	34	139	143	52	92	2" G	206	170	180	0,066	5,3

MODEL	VOLTAGE 50 Hz	CENTRE DISTANCE mm	UNIONS ON REQUEST	ELECTRICAL DATA						MINIMUM HEAD PRESSURE
				SPEED	N r.p.m.	P1 MAX W	In A	CAPACITOR		
				μF	Vc					
A 56/180 XT	3x400 V ~	180	2" G	2	2708	291	0,60	-	-	t° +90°C mt. 1,5
				1	2178	200	0,32	-	-	

## A 56/180 T SINGLE WITH UNIONS - THREE-PHASE

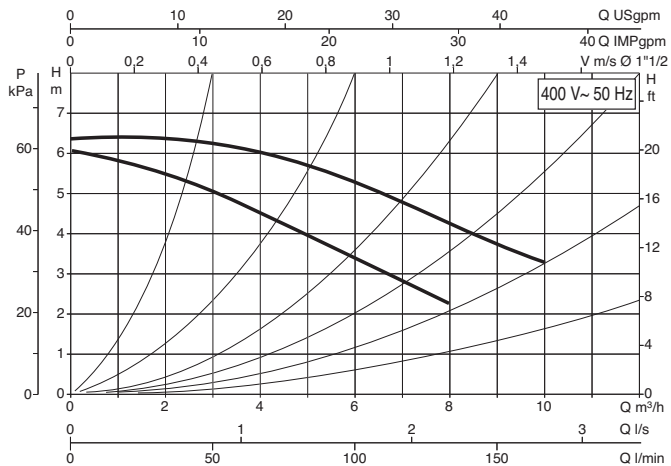
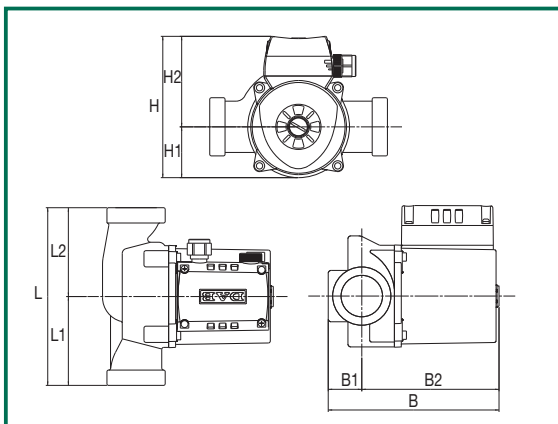

L	L1	L2	B	B1	B2	H	H1	H2	F	PACKING DIMENSIONS			VOLUME	WEIGHT
										L	B	H	m <sup>3</sup>	Kg
180	90	90	173	34	139	143	52	92	1" 1/2	206	170	180	0,066	5,2

MODEL	VOLTAGE 50 Hz	CENTRE DISTANCE mm	UNIONS ON REQUEST	ELECTRICAL DATA						MINIMUM HEAD PRESSURE
				SPEED	N r.p.m.	P1 MAX W	In A	CAPACITOR		
				μF	Vc					
A 56/180 T	3x400 V ~	180	1" 1/2	2	2704	297	0,60	-	-	t° +90°C mt. 1,5
				1	2178	200	0,33	-	-	

Performance curves based on kinematic viscosity values equal to 1 mm<sup>2</sup>/s at a density equal to 1000 kg/m<sup>3</sup>. Curve tolerance in accordance with ISO9906.

# CIRCULATORS FOR HEATING AND AIR-CONDITIONING SYSTEMS

Liquid temperature range: from -10°C to +110°C  
 Maximum operating pressure: 10 bar (1000 kPa)

## A 80/180 XM SINGLE WITH UNIONS - SINGLE-PHASE

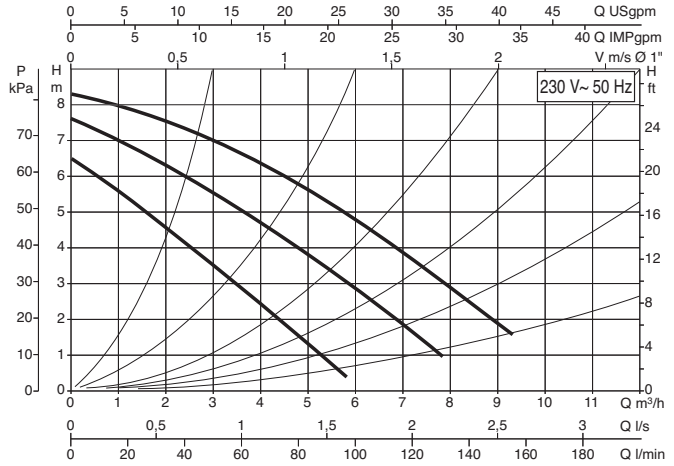
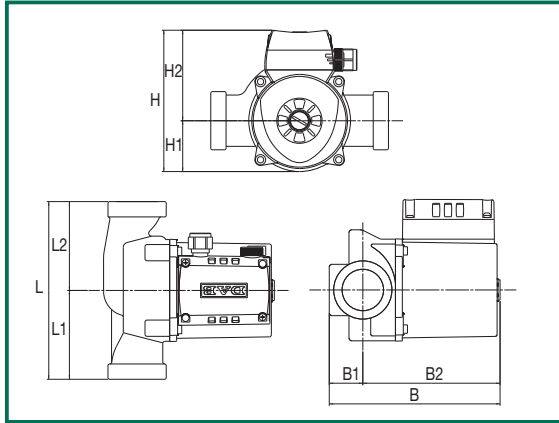

L	L1	L2	B	B1	B2	H	H1	H2	F	PACKING DIMENSIONS			VOLUME	WEIGHT
										L	B	H	m <sup>3</sup>	Kg
180	90	90	173	34	139	143	52	92	2" G	206	170	180	0,066	5,2

MODEL	VOLTAGE 50 Hz	CENTRE DISTANCE mm	UNIONS ON REQUEST	ELECTRICAL DATA						MINIMUM HEAD PRESSURE		
				SPEED	N r.p.m.	P1 MAX W	In A	CAPACITOR				
										μF	Vc	
A 80/180 XM	1x230 V ~	180	2" G	3	2683	256	1,12	7	400	t° +90°C mt. 2,5		
				2	2374	260	1,17					
				1	1688	218	1,00					

## A 80/180 M SINGLE WITH UNIONS - SINGLE-PHASE

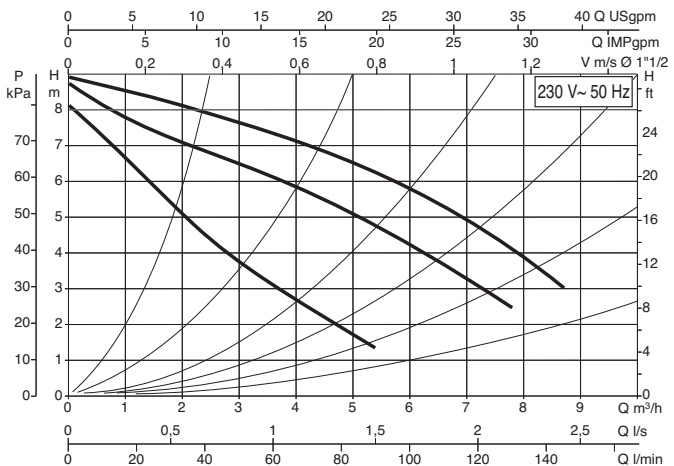
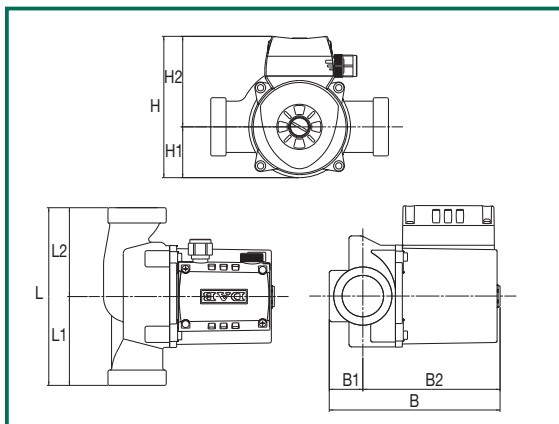

L	L1	L2	B	B1	B2	H	H1	H2	F	PACKING DIMENSIONS			VOLUME	WEIGHT
										L	B	H	m <sup>3</sup>	Kg
180	90	90	173	34	139	143	52	92	1" 1/2	206	170	180	0,066	5,3

MODEL	VOLTAGE 50 Hz	CENTRE DISTANCE mm	UNIONS ON REQUEST	ELECTRICAL DATA						MINIMUM HEAD PRESSURE		
				SPEED	N r.p.m.	P1 MAX W	In A	CAPACITOR				
										μF	Vc	
A 80/180 M	1x230 V ~	180	1" 1/2	3	2674	264	1,15	7	400	t° +90°C mt. 2,5		
				2	2356	262	1,20					
				1	1615	223	1,00					

Performance curves based on kinematic viscosity values equal to 1 mm<sup>2</sup>/s at a density equal to 1000 kg/m<sup>3</sup>. Curve tolerance in accordance with ISO9906.

# CIRCULATORS FOR HEATING AND AIR-CONDITIONING SYSTEMS

Liquid temperature range: from -10°C to +110°C  
 Maximum operating pressure: 10 bar (1000 kPa)

## A 80/180 XT SINGLE WITH UNIONS - THREE-PHASE

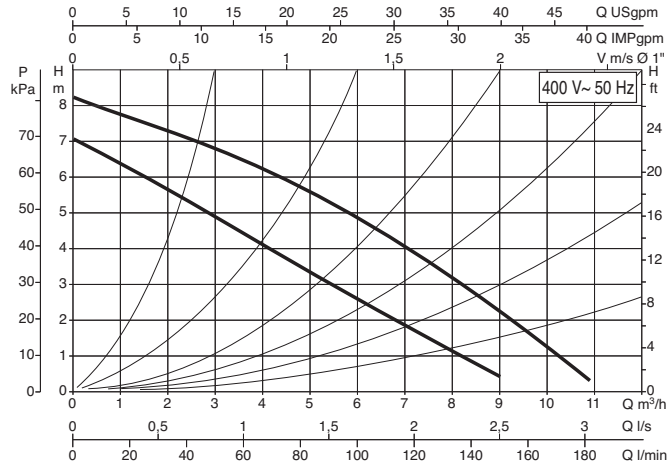
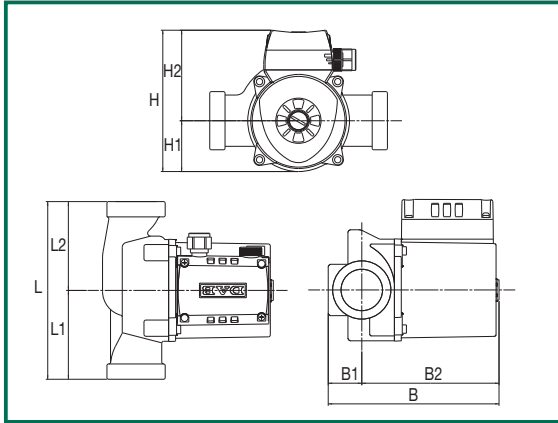

L	L1	L2	B	B1	B2	H	H1	H2	F	PACKING DIMENSIONS			VOLUME	WEIGHT
										L	B	H	m <sup>3</sup>	Kg
180	90	90	173	34	139	143	52	92	2" G	206	170	180	0,066	5,3

MODEL	VOLTAGE 50 Hz	CENTRE DISTANCE mm	UNIONS ON REQUEST	ELECTRICAL DATA						MINIMUM HEAD PRESSURE
				SPEED	N r.p.m.	P1 MAX W	In A	CAPACITOR		
				μF	Vc					
A 80/180 XT	3x400 V ~	180	2" G	2	2727	272	0,57	-	-	t° +90°C mt. 2,5
				1	2227	186	0,30	-	-	

## A 80/180 T SINGLE WITH UNIONS - THREE-PHASE

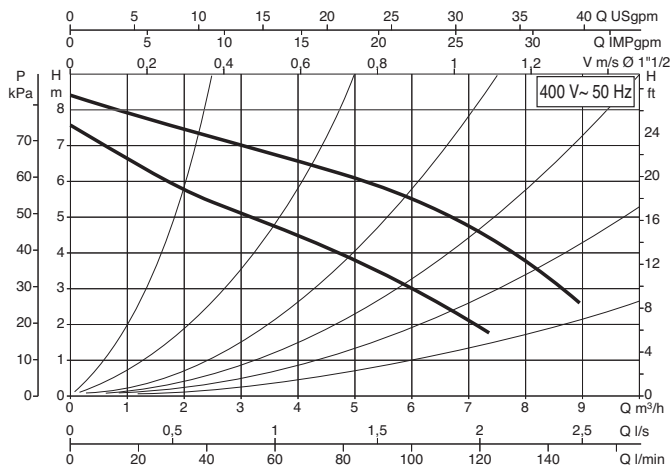
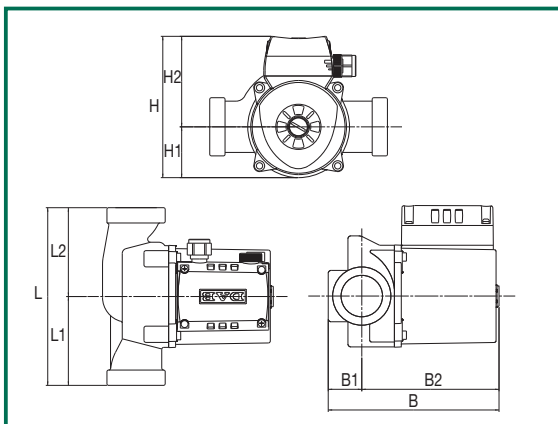

L	L1	L2	B	B1	B2	H	H1	H2	F	PACKING DIMENSIONS			VOLUME	WEIGHT
										L	B	H	m <sup>3</sup>	Kg
180	90	90	173	34	139	143	52	92	1" 1/2	206	170	180	0,066	5,3

MODEL	VOLTAGE 50 Hz	CENTRE DISTANCE mm	UNIONS ON REQUEST	ELECTRICAL DATA						MINIMUM HEAD PRESSURE
				SPEED	N r.p.m.	P1 MAX W	In A	CAPACITOR		
				μF	Vc					
A 80/180 T	3x400 V ~	180	1" 1/2	2	2724	271	0,57	-	-	t° +90°C mt. 2,5
				1	2226	187	0,31	-	-	



Performance curves based on kinematic viscosity values equal to 1 mm<sup>2</sup>/s at a density equal to 1000 kg/m<sup>3</sup>. Curve tolerance in accordance with ISO9906.

# CIRCULATORS FOR HEATING AND AIR-CONDITIONING SYSTEMS

Liquid temperature range: from -10°C to +110°C  
 Maximum operating pressure: 10 bar (1000 kPa)

## A 110/180 XM SINGLE WITH UNIONS - SINGLE-PHASE

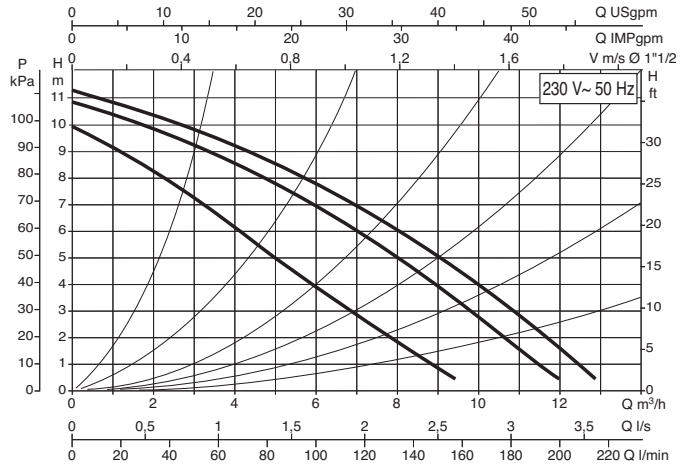
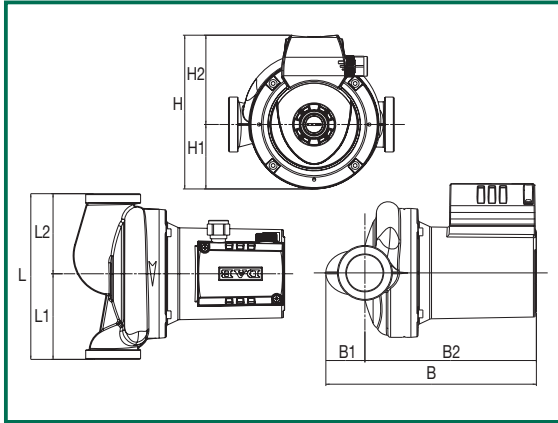

L	L1	L2	B	B1	B2	H	H1	H2	F	PACKING DIMENSIONS			VOLUME	WEIGHT
										L	B	H	m <sup>3</sup>	Kg
180	93	87	229	42	186	167	70	97	2" G	237	200	272	0,066	5,3

MODEL	VOLTAGE 50 Hz	CENTRE DISTANCE mm	UNIONS ON REQUEST	ELECTRICAL DATA						MINIMUM HEAD PRESSURE
				SPEED	N r.p.m.	P1 MAX W	In A	CAPACITOR µF	Vc	
A 110/180 XM	1x230 V ~	180	2" G	3	2746	410	1,12	12	450	t° +90°C mt. 2,5
				2	2552	393	1,17			
				1	2052	361	1,00			

## A 110/180 XT SINGLE WITH UNIONS - THREE-PHASE

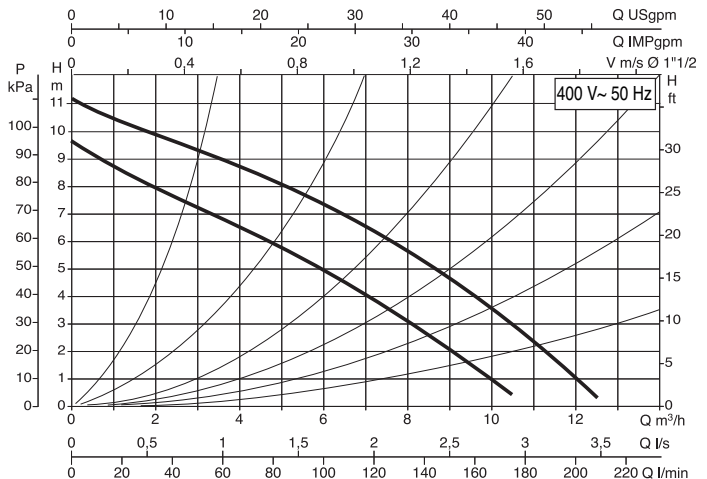
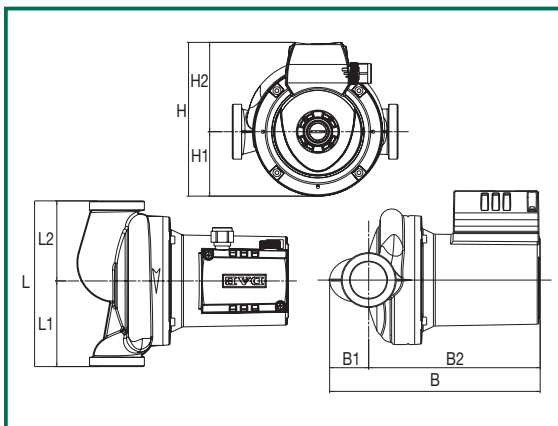

L	L1	L2	B	B1	B2	H	H1	H2	F	PACKING DIMENSIONS			VOLUME	WEIGHT
										L	B	H	m <sup>3</sup>	Kg
180	93	87	229	186	42	163	70	93	2" G	237	200	272	0,066	5,2

MODEL	VOLTAGE 50 Hz	CENTRE DISTANCE mm	UNIONS ON REQUEST	ELECTRICAL DATA						MINIMUM HEAD PRESSURE
				SPEED	N r.p.m.	P1 MAX W	In A	CAPACITOR µF	Vc	
A 110/180 XT	3x400 V ~	180	2" G	2	2759	403	0,90	-	-	t° +90°C mt. 2,5
				1	2341	289	0,48			

Performance curves based on kinematic viscosity values equal to 1 mm<sup>2</sup>/s at a density equal to 1000 kg/m<sup>3</sup>. Curve tolerance in accordance with ISO9906.

# CIRCULATORS FOR HEATING AND AIR-CONDITIONING SYSTEMS

Liquid temperature range: from -10°C to +110°C  
 Maximum operating pressure: 10 bar (1000 kPa)

## B 50/250.40 M SINGLE FLANGED - SINGLE-PHASE

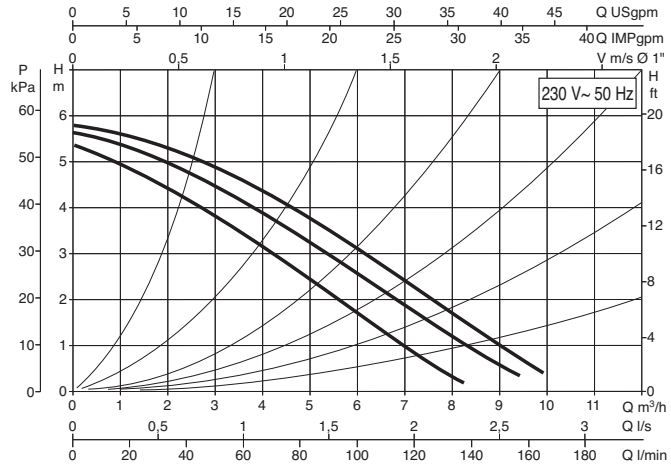
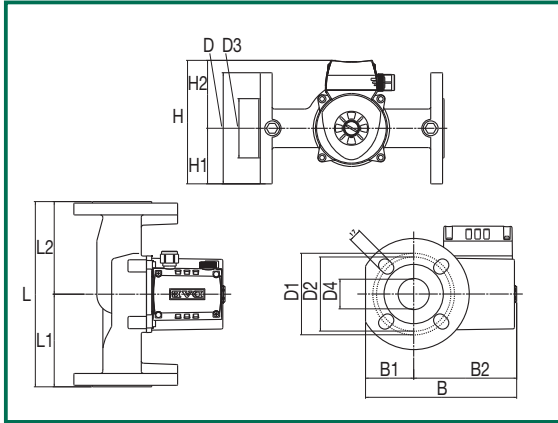

L	L1	L2	B	B1	B2	D	D1	D2	D3	D4	H	H1	H2	F	PACKING DIMENSIONS			VOLUME	WEIGHT
															L	B	H	m <sup>3</sup>	Kg
250	125	125	204	65	139	150	110	100	80	40	167	75	92	DN40/PN10	302	202	283	0,013	9,1

MODEL	VOLTAGE 50 Hz	CENTRE DISTANCE mm	UNIONS ON REQUEST	ELECTRICAL DATA						MINIMUM HEAD PRESSURE
				SPEED	N r.p.m.	P1 MAX W	In A	CAPACITOR		
				μF	Vc					
<b>B 50/250.40 M</b>	1x230 V ~	250	DN 40	3	2766	195	0,95	2,5	400	t° +90°C mt. 1,5
				2	2616	194	0,95			
				1	2215	180	0,85			

## B 50/250.40 T SINGLE FLANGED - THREE-PHASE

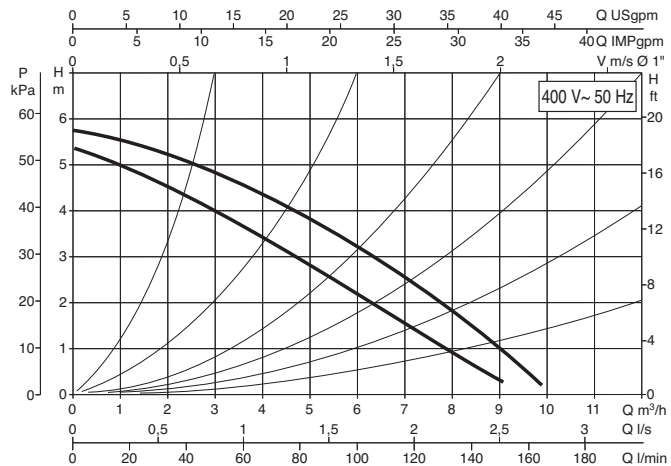
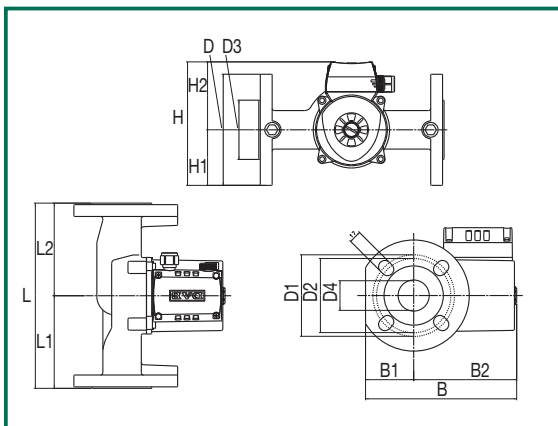

L	L1	L2	B	B1	B2	D	D1	D2	D3	D4	H	H1	H2	F	PACKING DIMENSIONS			VOLUME	WEIGHT
															L	B	H	m <sup>3</sup>	Kg
250	125	125	204	65	139	150	110	100	80	40	167	75	92	DN40/PN10	302	202	283	0,013	9,3

MODEL	VOLTAGE 50 Hz	CENTRE DISTANCE mm	UNIONS ON REQUEST	ELECTRICAL DATA						MINIMUM HEAD PRESSURE
				SPEED	N r.p.m.	P1 MAX W	In A	CAPACITOR		
				μF	Vc					
<b>B 50/250.40 T</b>	3x400 V ~	250	DN 40	2	2827	197	0,52	-	-	t° +90°C mt. 1,5
				1	2502	139	0,25			

Performance curves based on kinematic viscosity values equal to 1 mm<sup>2</sup>/s at a density equal to 1000 kg/m<sup>3</sup>. Curve tolerance in accordance with ISO9906.

# CIRCULATORS FOR HEATING AND AIR-CONDITIONING SYSTEMS

Liquid temperature range: from -10°C to +110°C  
 Maximum operating pressure: 10 bar (1000 kPa)

## B 56/250.40 M SINGLE FLANGED - SINGLE-PHASE

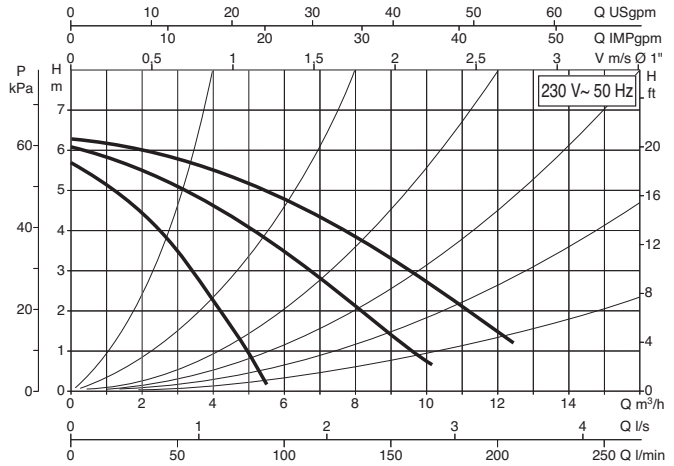
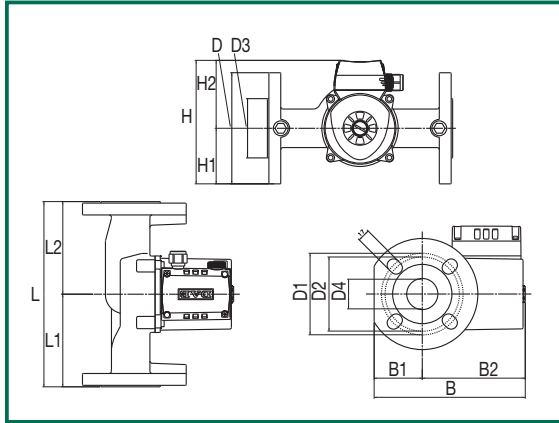

L	L1	L2	B	B1	B2	D	D1	D2	D3	D4	H	H1	H2	F	PACKING DIMENSIONS			VOLUME	WEIGHT
															L	B	H	m <sup>3</sup>	Kg
250	125	125	204	65	139	150	110	100	80	40	167	75	92	DN40/PN10	302	202	283	0,013	9,3

MODEL	VOLTAGE 50 Hz	CENTRE DISTANCE mm	UNIONS ON REQUEST	ELECTRICAL DATA						MINIMUM HEAD PRESSURE
				SPEED	N r.p.m.	P1 MAX W	In A	CAPACITOR		
				μF	Vc					
<b>B 56/250.40 M</b>	1x230 V ~	250	DN 40	3	2636	282	1,23	7	400	t° +90°C mt. 1,5
				2	2226	287	1,30			
				1	1485	228	1,06			

## B 56/250.40 T SINGLE FLANGED - THREE-PHASE

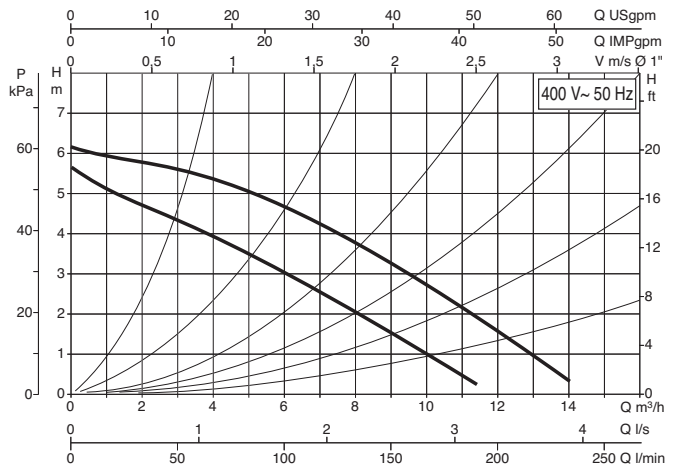
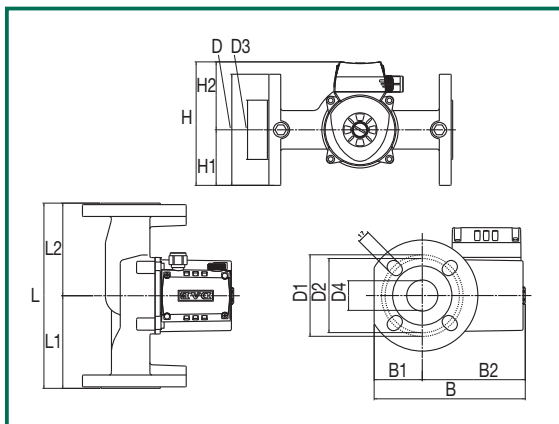

L	L1	L2	B	B1	B2	D	D1	D2	D3	D4	H	H1	H2	F	PACKING DIMENSIONS			VOLUME	WEIGHT
															L	B	H	m <sup>3</sup>	Kg
250	125	125	204	65	139	150	110	100	80	40	167	75	92	DN40/PN10	302	202	283	0,013	9,2

MODEL	VOLTAGE 50 Hz	CENTRE DISTANCE mm	UNIONS ON REQUEST	ELECTRICAL DATA						MINIMUM HEAD PRESSURE
				SPEED	N r.p.m.	P1 MAX W	In A	CAPACITOR		
				μF	Vc					
<b>B 56/250.40 T</b>	3x400 V ~	250	DN 40	2	2704	297	0,60	-	-	t° +90°C mt. 1,5
				1	2178	200	0,33			

Performance curves based on kinematic viscosity values equal to 1 mm<sup>2</sup>/s at a density equal to 1000 kg/m<sup>3</sup>. Curve tolerance in accordance with ISO9906.

# CIRCULATORS FOR HEATING AND AIR-CONDITIONING SYSTEMS

Liquid temperature range: from -10°C to +110°C  
 Maximum operating pressure: 10 bar (1000 kPa)

## B 80/250.40 M SINGLE FLANGED - SINGLE-PHASE

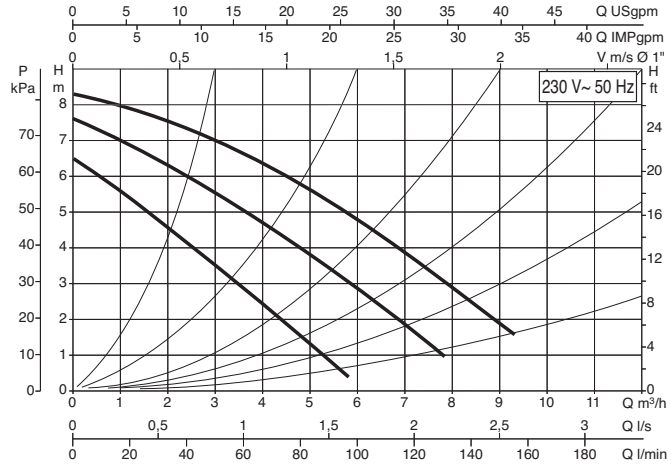
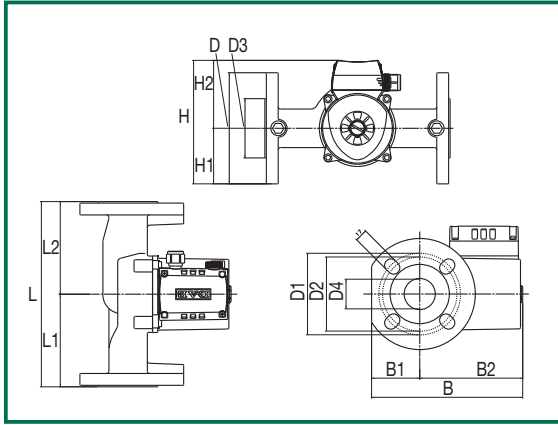

L	L1	L2	B	B1	B2	D	D1	D2	D3	D4	H	H1	H2	F	PACKING DIMENSIONS			VOLUME	WEIGHT
															L	B	H	m <sup>3</sup>	Kg
250	125	125	204	65	139	150	110	100	80	40	167	75	92	DN40/PN10	302	202	283	0,013	9,3

MODEL	VOLTAGE 50 Hz	CENTRE DISTANCE mm	UNIONS ON REQUEST	ELECTRICAL DATA						MINIMUM HEAD PRESSURE
				SPEED	N r.p.m.	P1 MAX W	In A	CAPACITOR		
								μF	Vc	
<b>B 80/250.40 M</b>	1x230 V ~	250	DN 40	3	2674	264	1,15	7	400	t° +90°C mt. 2,5
				2	2356	262	1,20			
				1	1615	223	1,00			

## B 80/250.40 T SINGLE FLANGED - THREE-PHASE

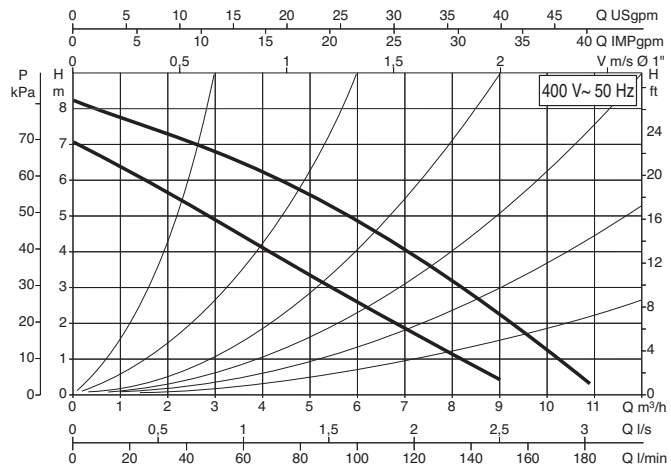
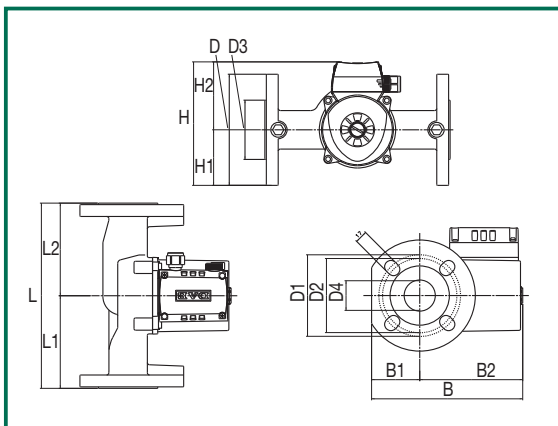

L	L1	L2	B	B1	B2	D	D1	D2	D3	D4	H	H1	H2	F	PACKING DIMENSIONS			VOLUME	WEIGHT
															L	B	H	m <sup>3</sup>	Kg
250	125	125	204	65	139	150	110	100	80	40	167	75	92	DN40/PN10	302	202	283	0,013	9,3

MODEL	VOLTAGE 50 Hz	CENTRE DISTANCE mm	UNIONS ON REQUEST	ELECTRICAL DATA						MINIMUM HEAD PRESSURE
				SPEED	N r.p.m.	P1 MAX W	In A	CAPACITOR		
								μF	Vc	
<b>B 80/250.40 T</b>	3x400 V ~	250	DN 40	2	2724	271	0,57	-	-	t° +90°C mt. 2,5
				1	2226	187	0,31			

Performance curves based on kinematic viscosity values equal to 1 mm<sup>2</sup>/s at a density equal to 1000 kg/m<sup>3</sup>. Curve tolerance in accordance with ISO9906.

# CIRCULATORS FOR HEATING AND AIR-CONDITIONING SYSTEMS

Liquid temperature range: from -10°C to +110°C  
 Maximum operating pressure: 10 bar (1000 kPa)

## B 110/250.40 M SINGLE FLANGED - SINGLE-PHASE

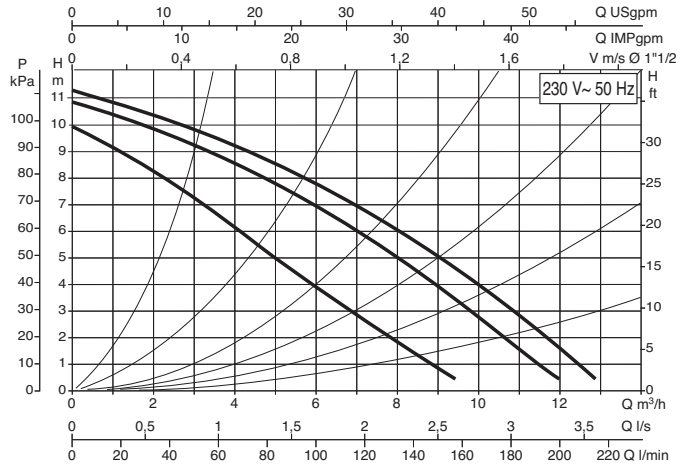
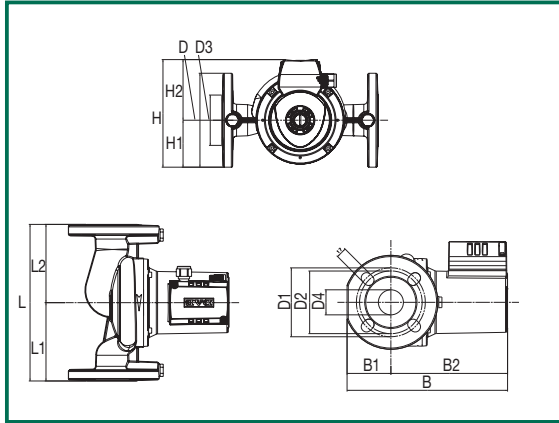

L	L1	L2	B	B1	B2	D	D1	D2	D3	D4	H	H1	H2	F	PACKING DIMENSIONS			VOLUME	WEIGHT
															L	B	H	m <sup>3</sup>	Kg
250	125	125	256	70	186	150	110	100	80	40	172	75	97	DN40/PN10	302	202	283	0,013	9,2

MODEL	VOLTAGE 50 Hz	CENTRE DISTANCE mm	UNIONS ON REQUEST	ELECTRICAL DATA						MINIMUM HEAD PRESSURE
				SPEED	N r.p.m.	P1 MAX W	In A	CAPACITOR		
								μF	Vc	
<b>B 110/250.40 M</b>	1x230 V ~	250	DN 40	3	2746	410	1,77	12	450	t° +90°C mt. 2,5
				2	2552	393	1,78			
				1	2052	361	1,64			

## B 110/250.40 T SINGLE FLANGED - THREE-PHASE

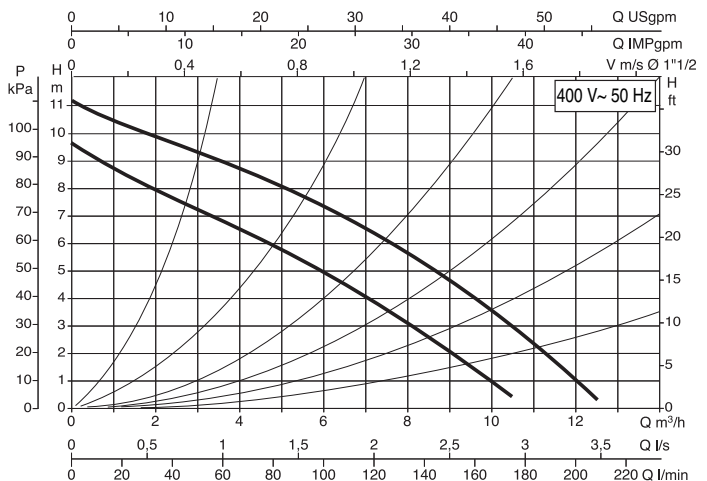
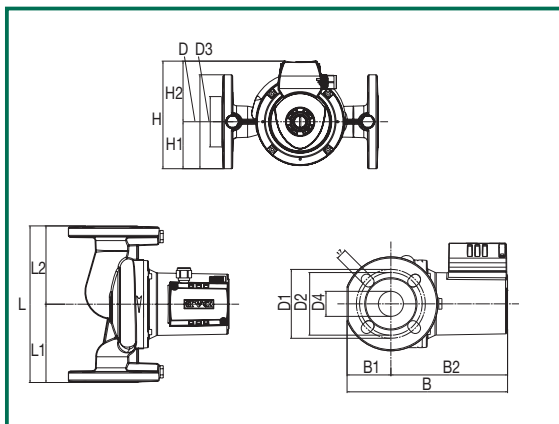

L	L1	L2	B	B1	B2	D	D1	D2	D3	D4	H	H1	H2	F	PACKING DIMENSIONS			VOLUME	WEIGHT
															L	B	H	m <sup>3</sup>	Kg
250	125	125	256	70	186	150	110	100	80	40	168	75	93	DN40/PN10	302	202	283	0,013	9,3

MODEL	VOLTAGE 50 Hz	CENTRE DISTANCE mm	UNIONS ON REQUEST	ELECTRICAL DATA						MINIMUM HEAD PRESSURE
				SPEED	N r.p.m.	P1 MAX W	In A	CAPACITOR		
								μF	Vc	
<b>B 110/250.40 T</b>	3x400 V ~	250	DN 40	2	2759	403	0,90	-	-	t° +90°C mt. 2,5
				1	2341	289	0,48			

Performance curves based on kinematic viscosity values equal to 1 mm<sup>2</sup>/s at a density equal to 1000 kg/m<sup>3</sup>. Curve tolerance in accordance with ISO9906.

# CIRCULATORS FOR HEATING AND AIR-CONDITIONING SYSTEMS

Liquid temperature range: from -10°C to +110°C  
 Maximum operating pressure: 10 bar (1000 kPa)

## D 50/250.40 M TWIN FLANGED - SINGLE-PHASE

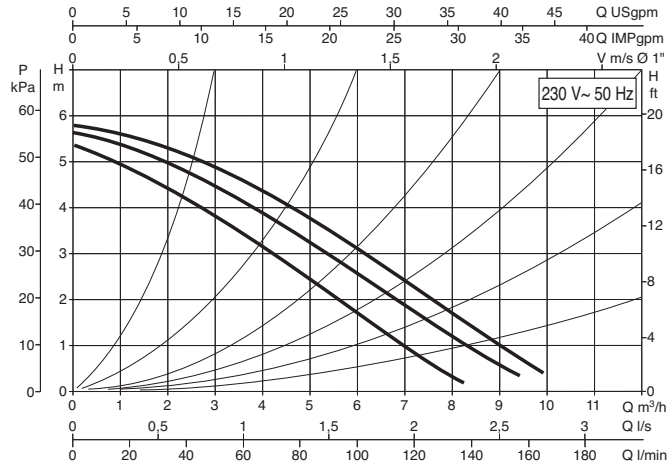
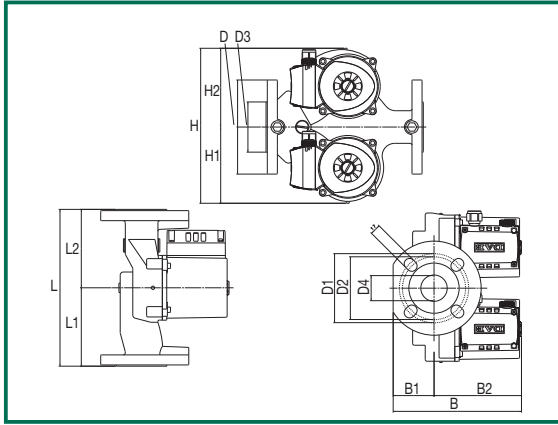

L	L1	L2	B	B1	B2	D	D1	D2	D3	D4	H	H1	H2	F	PACKING DIMENSIONS			VOLUME	WEIGHT
															L	B	H	m <sup>3</sup>	Kg
250	125	125	204	65	139	150	110	100	80	40	247	122	126	DN40/PN10	355	298	283	0,018	15,3

MODEL	VOLTAGE 50 Hz	CENTRE DISTANCE mm	UNIONS ON REQUEST	ELECTRICAL DATA*						MINIMUM HEAD PRESSURE
				SPEED	N r.p.m.	P1 MAX W	In A	CAPACITOR		
				μF	Vc					
<b>D 50/250.40 M</b>	1x230 V ~	250	DN 40 - PN 10	3	2766	195	0,95	2,5	400	t° +90°C mt. 1,5
				2	2616	194	0,95			
				1	2215	180	0,85			

\* Electrical data are related to only one motor in operation.

## D 50/250.40 T TWIN FLANGED - THREE-PHASE

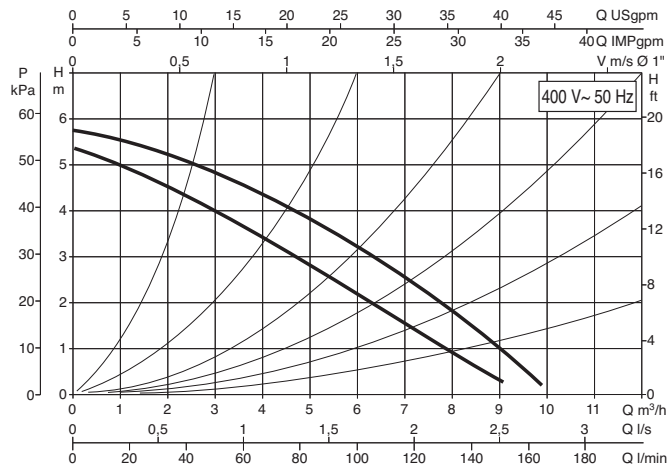
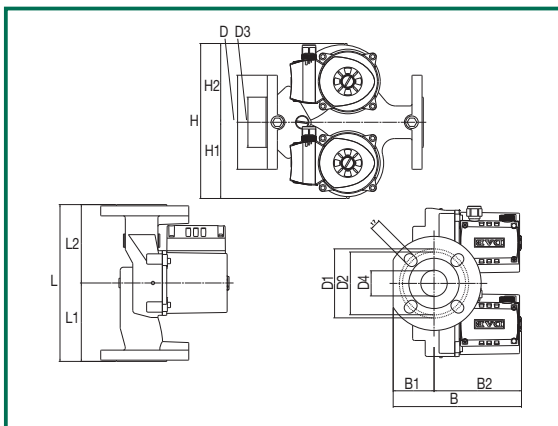

L	L1	L2	B	B1	B2	D	D1	D2	D3	D4	H	H1	H2	F	PACKING DIMENSIONS			VOLUME	WEIGHT
															L	B	H	m <sup>3</sup>	Kg
250	125	125	204	65	139	150	110	100	80	40	247	122	126	DN40/PN10	355	298	283	0,018	15,8

MODEL	VOLTAGE 50 Hz	CENTRE DISTANCE mm	UNIONS ON REQUEST	ELECTRICAL DATA*						MINIMUM HEAD PRESSURE
				SPEED	N r.p.m.	P1 MAX W	In A	CAPACITOR		
				μF	Vc					
<b>D 50/250.40 T</b>	3x400 V ~	250	DN 40 - PN 10	2	2827	197	0,52	-	-	t° +90°C mt. 1,5
				1	2502	139	0,25			

\* Electrical data are related to only one motor in operation.

Performance curves based on kinematic viscosity values equal to 1 mm<sup>2</sup>/s at a density equal to 1000 kg/m<sup>3</sup>. Curve tolerance in accordance with ISO9906.

# CIRCULATORS FOR HEATING AND AIR-CONDITIONING SYSTEMS

Liquid temperature range: from -10°C to +110°C  
 Maximum operating pressure: 10 bar (1000 kPa)

## D 56/250.40 M TWIN FLANGED - SINGLE-PHASE

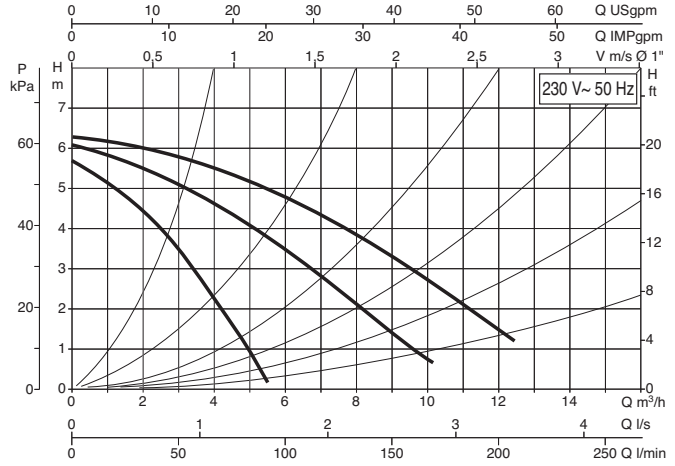
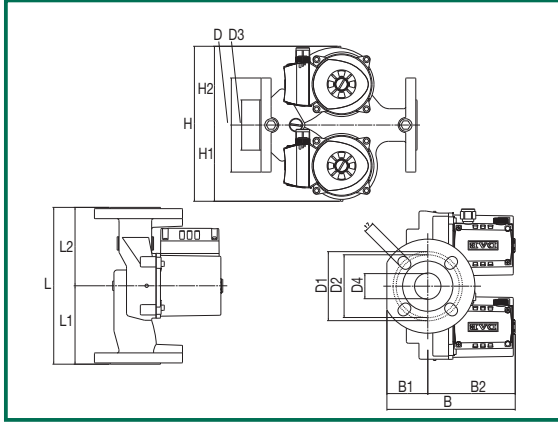

L	L1	L2	B	B1	B2	D	D1	D2	D3	D4	H	H1	H2	F	PACKING DIMENSIONS			VOLUME	WEIGHT
															L	B	H	m <sup>3</sup>	Kg
250	125	125	204	65	139	150	110	100	80	40	247	122	126	DN40/PN10	355	298	283	0,018	15,8

MODEL	VOLTAGE 50 Hz	CENTRE DISTANCE mm	UNIONS ON REQUEST	ELECTRICAL DATA*						MINIMUM HEAD PRESSURE
				SPEED	N r.p.m.	P1 MAX W	In A	CAPACITOR		
				μF	Vc					
<b>D 56/250.40 M</b>	1x230 V ~	250	DN 40 - PN 10	3	2636	282	1,23	7	400	t° +90°C mt. 1,5
				2	2226	287	1,30			
				1	1485	228	1,06			

\* Electrical data are related to only one motor in operation.

## D 56/250.40 T TWIN FLANGED - THREE-PHASE

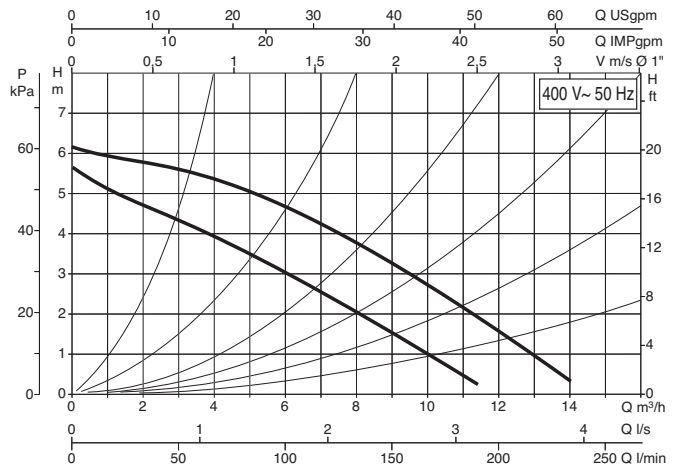
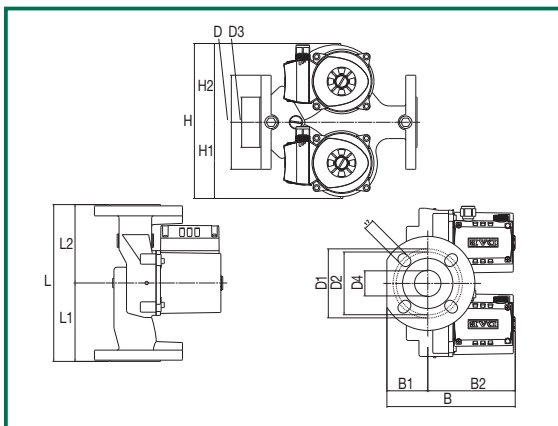

L	L1	L2	B	B1	B2	D	D1	D2	D3	D4	H	H1	H2	F	PACKING DIMENSIONS			VOLUME	WEIGHT
															L	B	H	m <sup>3</sup>	Kg
250	125	125	204	65	139	150	110	100	80	40	247	122	126	DN40/PN10	355	298	283	0,018	15,4

MODEL	VOLTAGE 50 Hz	CENTRE DISTANCE mm	UNIONS ON REQUEST	ELECTRICAL DATA*						MINIMUM HEAD PRESSURE
				SPEED	N r.p.m.	P1 MAX W	In A	CAPACITOR		
				μF	Vc					
<b>D 56/250.40 T</b>	3x400 V ~	250	DN 40 - PN 10	2	2704	297	0,60	-	-	t° +90°C mt. 1,5
				1	2178	200	0,33			

\* Electrical data are related to only one motor in operation.

Performance curves based on kinematic viscosity values equal to 1 mm<sup>2</sup>/s at a density equal to 1000 kg/m<sup>3</sup>. Curve tolerance in accordance with ISO9906.

# CIRCULATORS FOR HEATING AND AIR-CONDITIONING SYSTEMS

Liquid temperature range: from -10°C to +110°C  
 Maximum operating pressure: 10 bar (1000 kPa)

## D 80/250.40 M TWIN FLANGED - SINGLE-PHASE

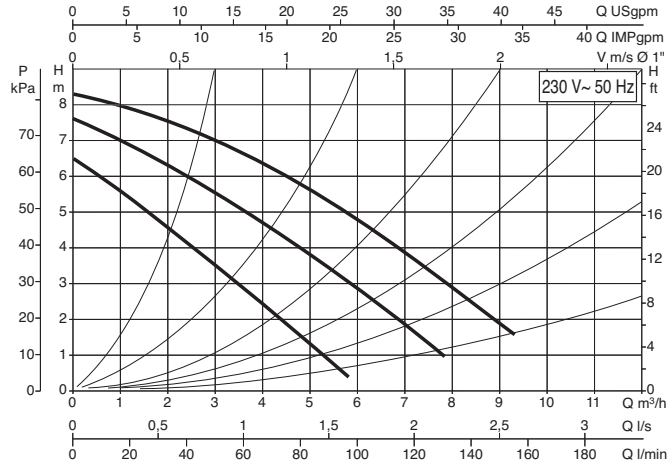
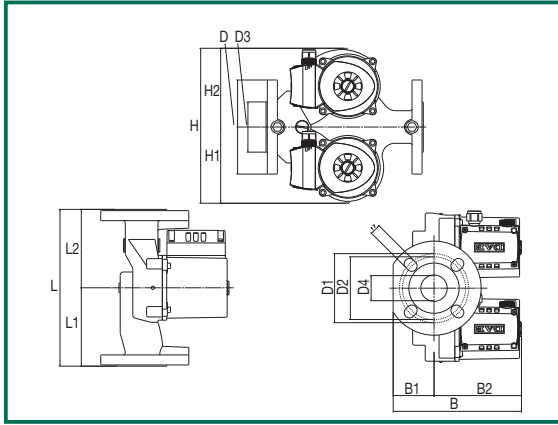

L	L1	L2	B	B1	B2	D	D1	D2	D3	D4	H	H1	H2	F	PACKING DIMENSIONS			VOLUME	WEIGHT
															L	B	H	m <sup>3</sup>	Kg
250	125	125	204	65	139	150	110	100	80	40	247	122	126	DN40/PN10	355	298	283	0,018	15,8

MODEL	VOLTAGE 50 Hz	CENTRE DISTANCE mm	UNIONS ON REQUEST	ELECTRICAL DATA*						MINIMUM HEAD PRESSURE
				SPEED	N r.p.m.	P1 MAX W	In A	CAPACITOR		
				μF	Vc					
<b>D 80/250.40 M</b>	1x230 V ~	250	DN 40 - PN 10	3	2674	264	1,15	7	400	t° +90°C mt. 2,5
				2	2356	262	1,20			
				1	1615	223	1,00			

\* Electrical data are related to only one motor in operation.

## D 80/250.40 T TWIN FLANGED - THREE-PHASE

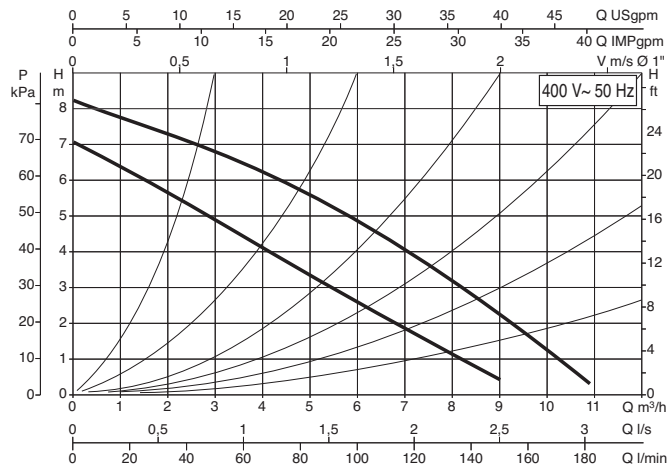
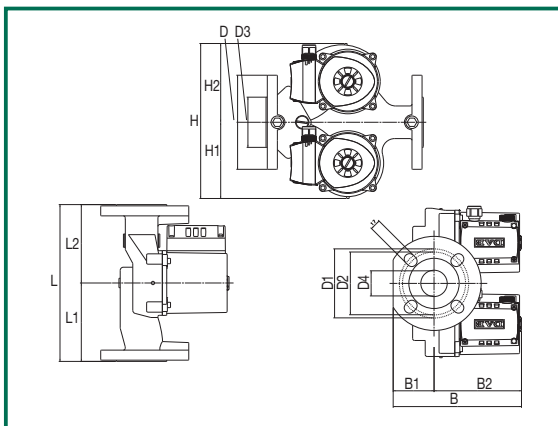

L	L1	L2	B	B1	B2	D	D1	D2	D3	D4	H	H1	H2	F	PACKING DIMENSIONS			VOLUME	WEIGHT
															L	B	H	m <sup>3</sup>	Kg
250	125	125	204	65	139	150	110	100	80	40	247	122	126	DN40/PN10	355	298	283	0,018	15,8

MODEL	VOLTAGE 50 Hz	CENTRE DISTANCE mm	UNIONS ON REQUEST	ELECTRICAL DATA*						MINIMUM HEAD PRESSURE
				SPEED	N r.p.m.	P1 MAX W	In A	CAPACITOR		
				μF	Vc					
<b>D 80/250.40 T</b>	3x400 V ~	250	DN 40 - PN 10	2	2724	271	0,57	-	-	t° +90°C mt. 2,5
				1	2226	187	0,31			

\* Electrical data are related to only one motor in operation.



Performance curves based on kinematic viscosity values equal to 1 mm<sup>2</sup>/s at a density equal to 1000 kg/m<sup>3</sup>. Curve tolerance in accordance with ISO9906.

# CIRCULATORS FOR HEATING AND AIR-CONDITIONING SYSTEMS

Liquid temperature range: from -10°C to +110°C  
 Maximum operating pressure: 10 bar (1000 kPa)

## D 110/250.40 M TWIN FLANGED - SINGLE-PHASE

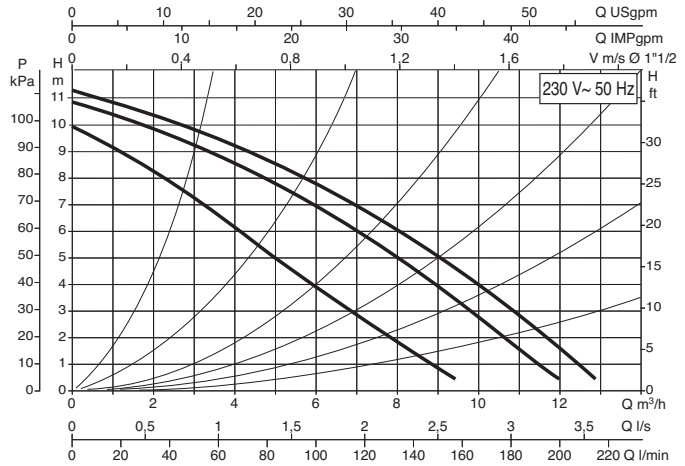
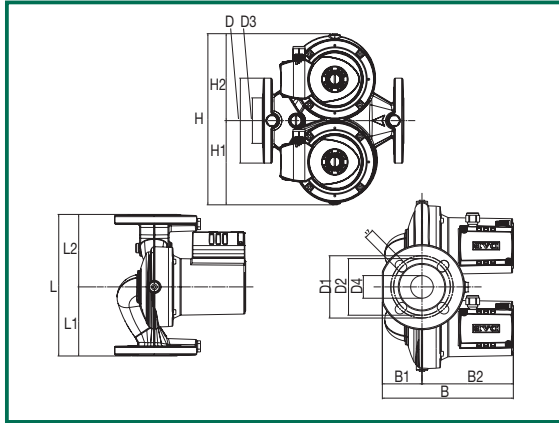

L	L1	L2	B	B1	B2	D	D1	D2	D3	D4	H	H1	H2	F	PACKING DIMENSIONS			VOLUME	WEIGHT
															L	B	H	m <sup>3</sup>	Kg
250	122	128	231	70	161	150	110	100	80	40	302	149	154	DN40/PN10	355	298	283	0,018	16

MODEL	VOLTAGE 50 Hz	CENTRE DISTANCE mm	UNIONS ON REQUEST	ELECTRICAL DATA*						MINIMUM HEAD PRESSURE
				SPEED	N r.p.m.	P1 MAX W	In A	CAPACITOR		
				μF	Vc					
<b>D 110/250.40 M</b>	1x230 V ~	250	DN 40 - PN 10	3	2746	410	1,77	12	450	t° +90°C mt. 2,5
				2	2552	393	1,78			
				1	2052	361	1,64			

\* Electrical data are related to only one motor in operation.

## D 110/250.40 T TWIN FLANGED - THREE-PHASE

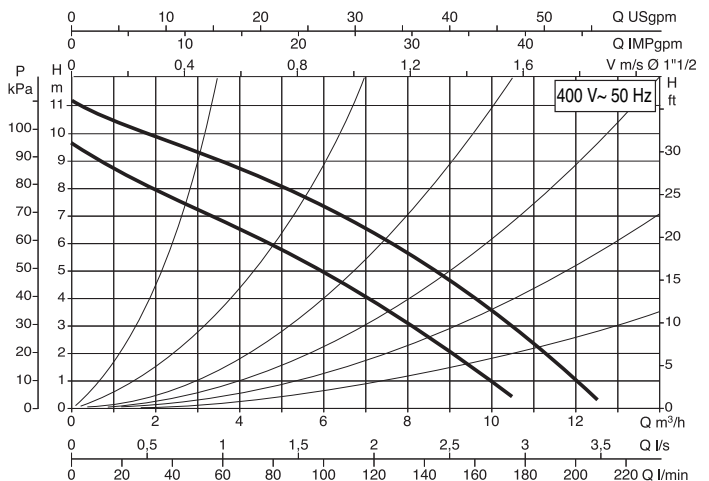
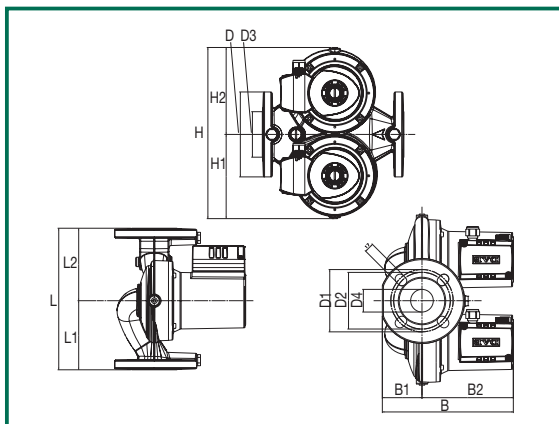

L	L1	L2	B	B1	B2	D	D1	D2	D3	D4	H	H1	H2	F	PACKING DIMENSIONS			VOLUME	WEIGHT
															L	B	H	m <sup>3</sup>	Kg
250	122	128	231	70	161	150	110	100	80	40	302	149	154	DN40/PN10	355	298	283	0,018	15,8

MODEL	VOLTAGE 50 Hz	CENTRE DISTANCE mm	UNIONS ON REQUEST	ELECTRICAL DATA*						MINIMUM HEAD PRESSURE
				SPEED	N r.p.m.	P1 MAX W	In A	CAPACITOR		
				μF	Vc					
<b>D 110/250.40 T</b>	3x400 V ~	250	DN 40 - PN 10	2	2759	403	0,90	-	-	t° +90°C mt. 2,5
				1	2341	289	0,48			

\* Electrical data are related to only one motor in operation.